



The Residence 2

MODEL ADDRESS
5227 Caneva Court
Antioch, CA 94531

Dayna Floyd | (925) 255-1808
dfloyd@denovahomes.com



STARTING AT
\$686,500

1,661 Sq. Ft.
1 Story
4 Bed
2 Bath
2 Car Garage

Beautiful single-level home with 1,661 Sq. Ft. (approx.) of living space, 4 bedrooms, 2 baths, and a 2-car garage!

This

floor plan has plenty of room to entertain friends and family with an expansive Great Room, large Family Dining, and gourmet Kitchen with granite countertops, 6" backsplash, and full-height at cooktop in 3 color choices, kitchen island overlooking the family dining area, stainless steel single basin kitchen sink, Beech cabinets with recessed panels in 2 stain choices, LG stainless steel kitchen appliances including 5-burner smart wi-fi enabled 30" self-cleaning gas range with a microhood and dishwasher. This home also includes a centrally located Laundry Room with pre-plumbing for a washer and dryer, spacious secondary bedrooms, a large Owner's Suite with an expansive walk-in closet, and an adjoining private bath with dual vanities with E-Stone countertops, 4" splash and undermount rectangular sinks, polished chrome hardware and bath accessories, designer-selected overhead chrome lighting, spacious fiberglass shower with glass and chrome enclosure and square-cut

vanity mirrors. This home also comes with hand-laid 18" x 18" ceramic tile flooring at Entry, Kitchen, Dining Room, and Owner's Bathroom, hand-laid 12" x 12" ceramic tile flooring in all secondary baths and Laundry, designer selected carpet in all other rooms including stairs, smart thermostat, tankless water heater, a video doorbell, and much more! Please see the Sales Agent for complete details.





The Residence 2

MODEL ADDRESS
5227 Caneva Court
Antioch, CA 94531

Dayna Floyd | (925) 255-1808
dfloyd@denovahomes.com

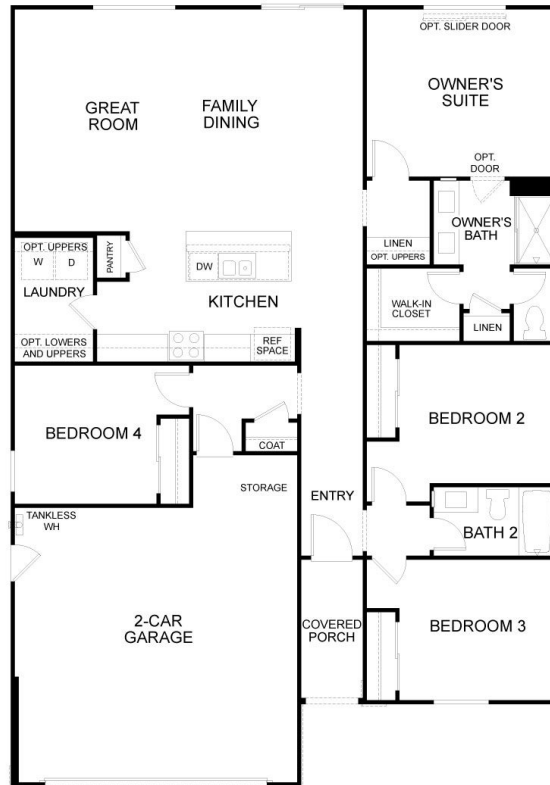

Floor Plan

