

UNDER
CONSTRUCTION

\$879,900

THE GREENWAY - RESIDENCE 2

Craftsman

1,711 Sq. Ft.

1 Story

2 Bed

2 Bath

2 Car Garage



Greenway Residence 2 elevates the concept of comfortable living, offering 2 bedrooms, 2 bathrooms, a tech center, and two patios across 1,711 square feet. This thoughtfully designed home features a central patio that creates a seamless indoor-outdoor living experience, allowing natural light to flow through the great room, dining, and kitchen areas. The tech center, strategically located between the kitchen and hallway, provides a convenient space for work or study, blending effortlessly into the home's layout.

The kitchen boasts Quartz countertops with a 6-inch backsplash and stylish Beech/Shaker door cabinets, available in three elegant color choices. LG stainless steel appliances and a sleek stainless steel sink complete the space, offering both function and style. The home also includes durable 17x17 hand-laid tile flooring and smart home features like a thermostat and video doorbell.

Homeowners can further personalize their space with the option to add a 417 square-foot loft or ADU, giving flexibility for guest accommodations or additional living space.

Please see the Sales Agent for Complete Details.

PRELIMINARY



**OPTIONAL
SECOND FLOOR
ELEVATION A**

OPTIONS

DENOVA
BRETTON WOODS
PLAN G2A

Greenway - Residence 2A

PRELIMINARY

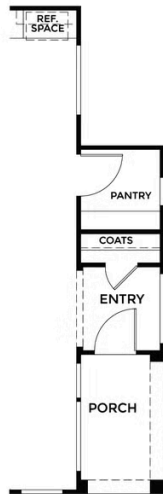

FIRST FLOOR
ELEVATION B



OPTIONAL
SECOND FLOOR
ELEVATION B

ELEVATION

DENOVA
BRETTON WOODS
PLAN G2A

Greenway - Residence 2B

PRELIMINARY

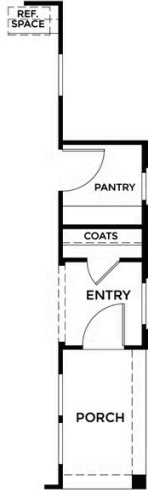

FIRST FLOOR
ELEVATION C



OPTIONAL
SECOND FLOOR
ELEVATION C

ELEVATION

DENOVA
BRETTON WOODS
PLAN G2A

Greenway - Residence 2C

PRELIMINARY

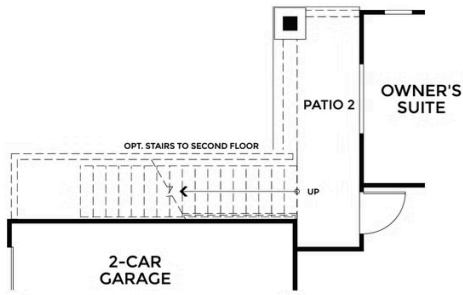

FIRST FLOOR
 ELEVATION D

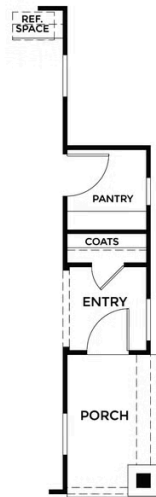

ELEVATION



OPTIONAL
 SECOND FLOOR
 ELEVATION D

DENOVA
 BRETTON WOODS
 PLAN G2A

Greenway - Residence 2D