



STARTING AT
\$696,900

2,153 Sq. Ft.

2 Story

4 Bed

3 Bath

2 Car Garage

Cattle Ridge Residence 2 invites you to embrace 2,153 square feet of elevated living, where elegance and comfort seamlessly come together. This two-story stunner features 4 bedrooms, 3 full bathrooms, and a flexible loft, all designed to create a perfect blend of style and practicality. The first-floor bedroom and full bath offer a welcoming haven for guests or an ideal space for multi-generational living.

The heart of the home is designed for entertainment, with a seamless layout connecting the kitchen, dining, and living areas, perfectly suited for any occasion. Take the experience outdoors with an optional covered patio, turning your backyard into a dreamy alfresco retreat for sunrise coffees, afternoons lounging, or star-filled evenings under the open sky.



Residence 2A | Spanish



Residence 2B | Tuscan



Residence 2E | Farmhouse

All renderings are artist's conception. Actual porch and window configuration varies from artists renderings. DeNova Homes reserves the right to make changes in price, material, and specifications without notice and without liability for such changes. Broker cooperation welcome. Sales & marketing by DeNova Homes Sales, DRE #01247582 Equal Housing Opportunity.



PRELIMINARY



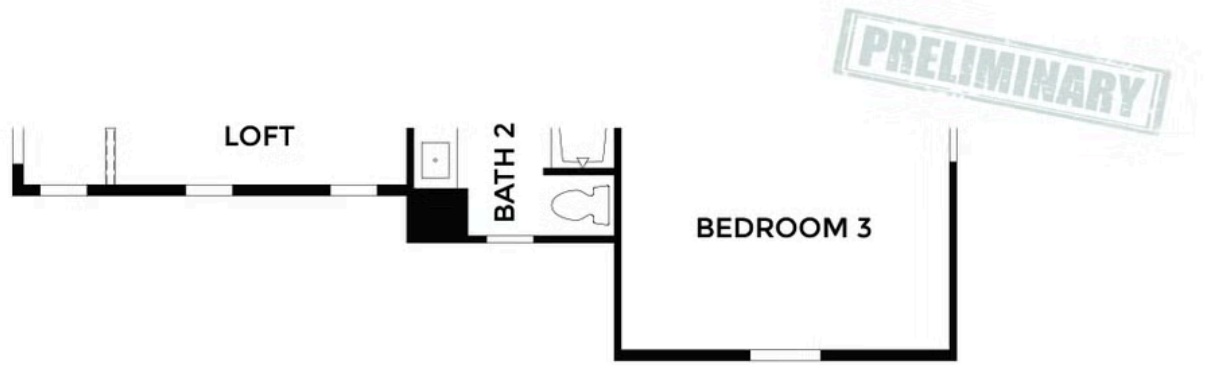

**ELEVATION TUSCAN
SECOND FLOOR
(SAME AS SPANISH)**

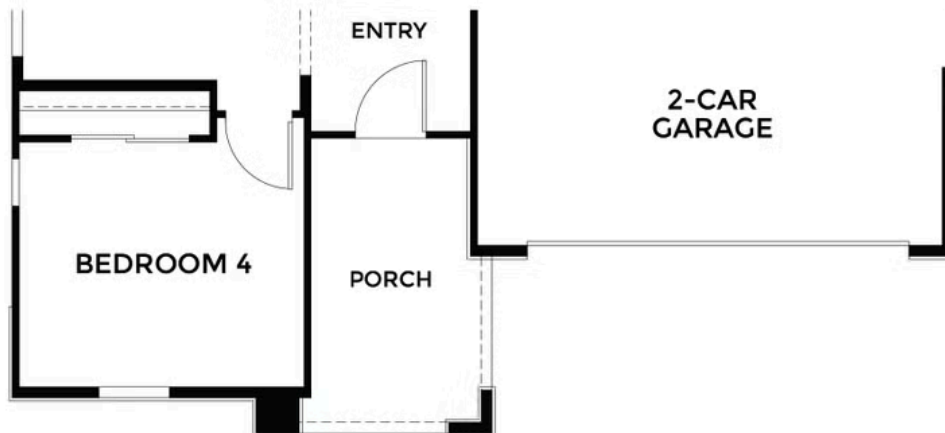

**ELEVATION TUSCAN
FIRST FLOOR**

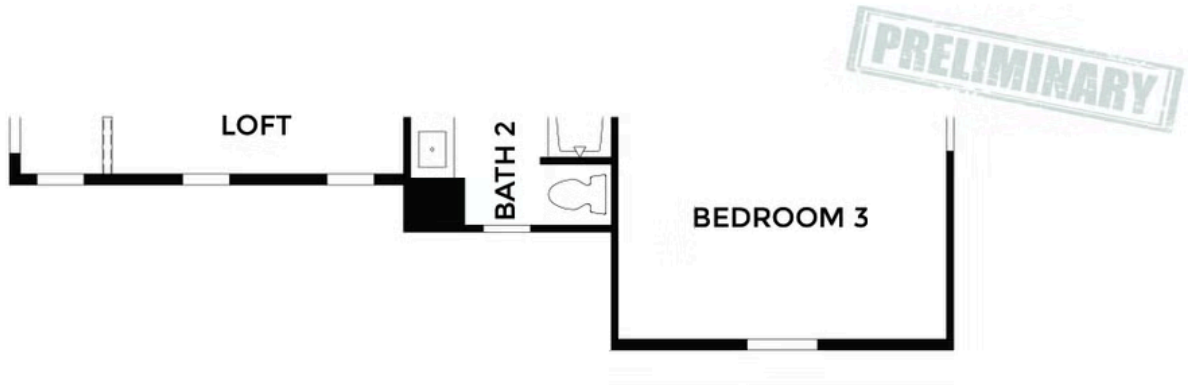

**ELEVATION FARMHOUSE
SECOND FLOOR
(SAME AS SPANISH)**

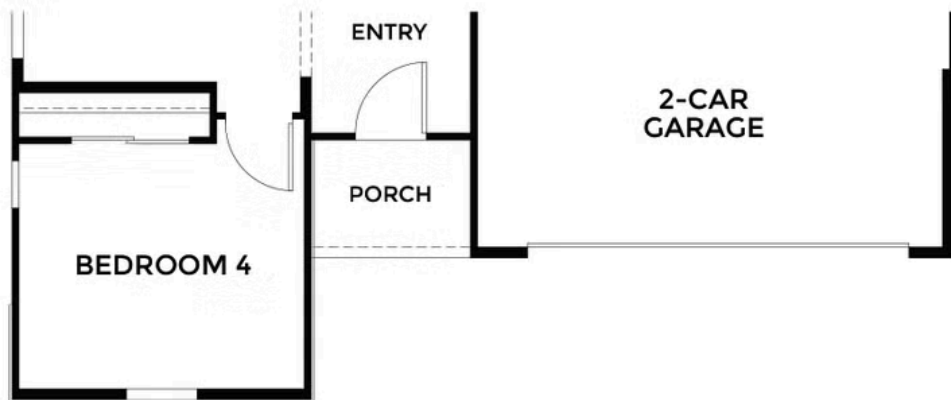

**ELEVATION FARMHOUSE
FIRST FLOOR**

PRELIMINARY

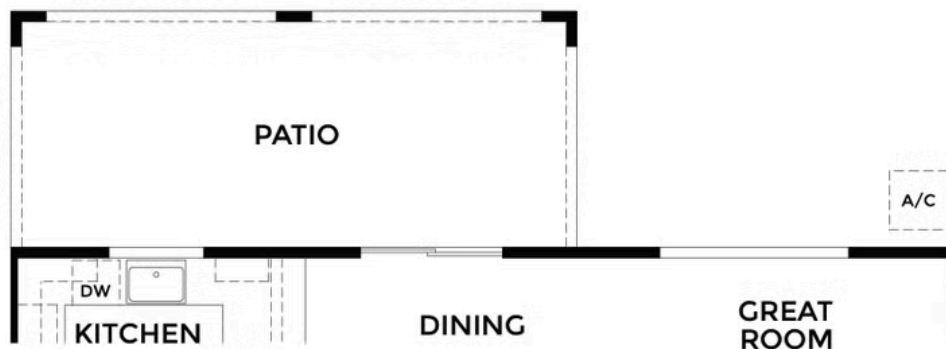

**OPTIONAL
PATIO**