

UNDER  
CONSTRUCTION

**\$812,900**

**THE RESIDENCE 9**

Farmhouse

2,666 Sq. Ft.

2 Story

4 Bed

3.5 Bath

2 Car Garage



Saddle Creek Residence 9 features 4 bedrooms, a loft or optional fifth bedroom, 3 full bathrooms, and a convenient half bath. This expansive two-story floor plan spans 2,666 square feet, offering adaptable living space designed to suit a variety of lifestyle needs.

The open and spacious living area is perfect for both intimate family gatherings and lively entertainment. The well-equipped kitchen caters to the home chef, while the great room provides a seamless flow for socializing. The downstairs bedroom, featuring an ensuite bathroom, adds versatility, serving as a cozy guest suite, multi-generational living, a comfortable home office, or a cheerful playroom. Its privacy offers the freedom to customize your living space to fit your family's unique lifestyle.

Ascend to the upper level, where you will discover the expansive owner's suite, a sanctuary with its elegant design and serene ambiance. This luxurious retreat features a beautifully appointed bathroom, complete with modern fixtures and finishes, and two spacious walk-in closets that provide ample storage while adding a touch of indulgence. Additional secondary bedrooms offer comfort for the whole family, and a versatile loft or optional fifth bedroom presents alternatives to personalize your home.

Elevate your outdoor experience with the option of a covered patio, ideal for alfresco dining or enjoying a book in the fresh air. With three distinct exterior elevations, this home highlights a unique character, complemented by a convenient 2-car garage that blends functionality with style.

**Please consult with sales agent for complete details**

All renderings are artist's conception. Actual porch and window configuration varies from artists renderings. DeNova Homes reserves the right to make changes in price, material, and specifications without notice and without liability for such changes. Broker cooperation welcome. Sales & marketing by DeNova Homes Sales, DRE #01247582 Equal Housing Opportunity.





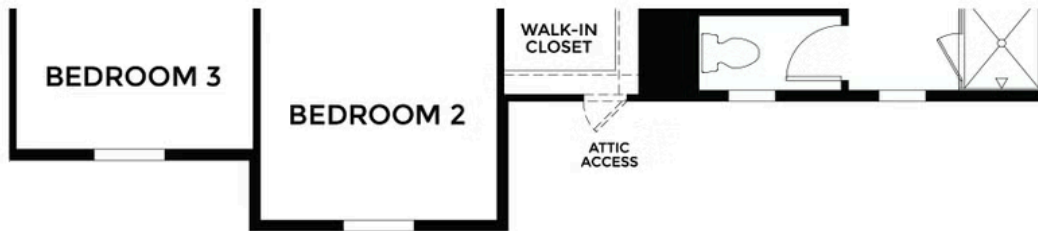

**ELEVATION PRAIRIE  
SECOND FLOOR  
(SAME AS SPANISH)**

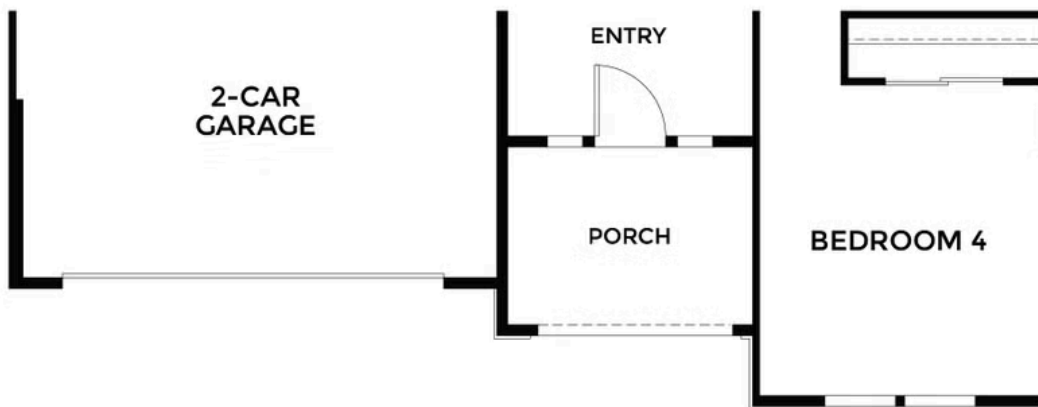

**ELEVATION PRAIRIE  
FIRST FLOOR**

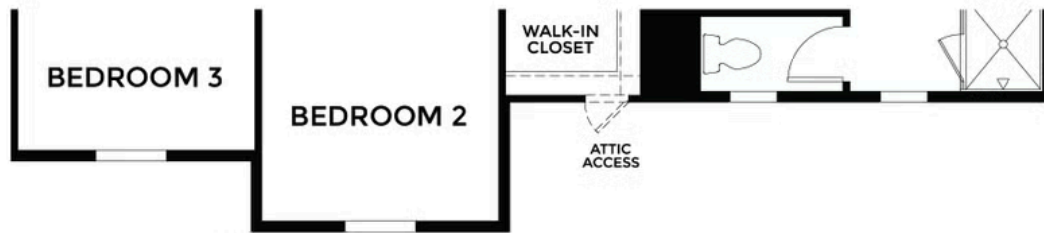

ELEVATION FARMHOUSE  
SECOND FLOOR  
(SAME AS SPANISH)

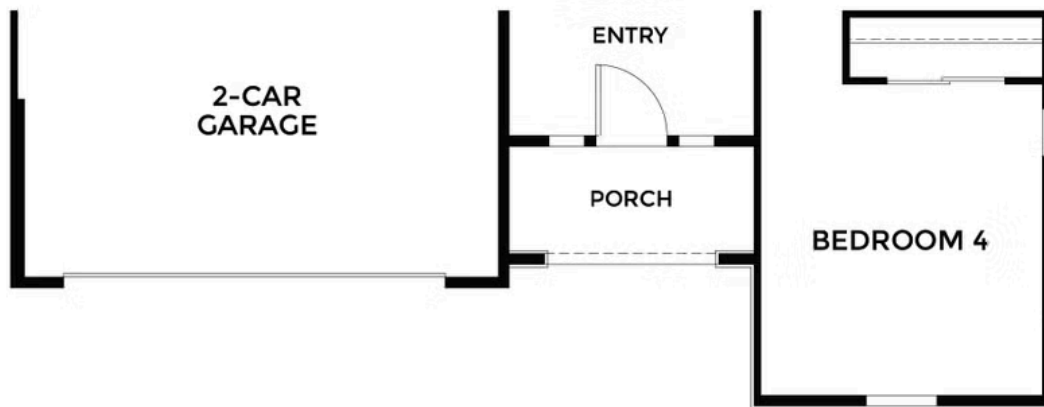

ELEVATION FARMHOUSE  
FIRST FLOOR

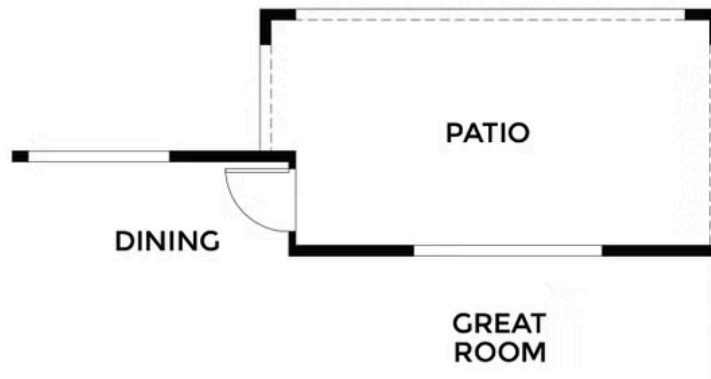

OPTIONAL PATIO



OPTIONAL BEDROOM 5  
ILO LOFT