



STARTING AT
\$770,900

2,666 Sq. Ft.

2 Story

4 Bed

3.5 Bath

2 Car Garage

Saddle Creek Residence 9 features 4 bedrooms, a loft or optional fifth bedroom, 3 full bathrooms, and a convenient half bath. This expansive two-story floor plan spans 2,666 square feet, offering adaptable living space designed to suit a variety of lifestyle needs.

The open and spacious living area is perfect for both intimate family gatherings and lively entertainment. The well-equipped kitchen caters to the home chef, while the great room provides a seamless flow for socializing. The downstairs bedroom, featuring an ensuite bathroom, adds versatility, serving as a cozy guest suite, multi-generational living, a comfortable home office, or a cheerful playroom. Its privacy offers the freedom to customize your living space to fit your family's unique lifestyle.



Residence 9A | Spanish



Residence 9C | Prairie



Residence 9E | Farmhouse





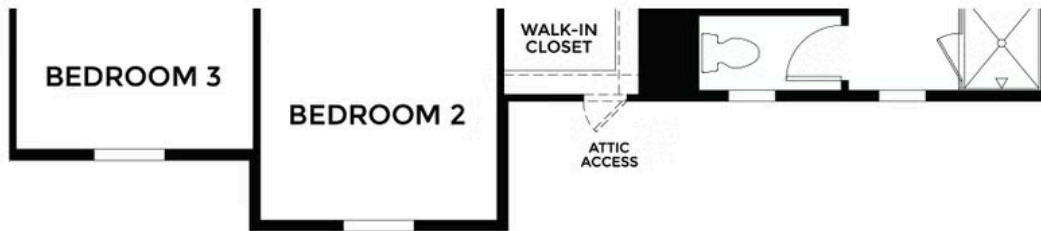

**ELEVATION PRAIRIE
SECOND FLOOR
(SAME AS SPANISH)**

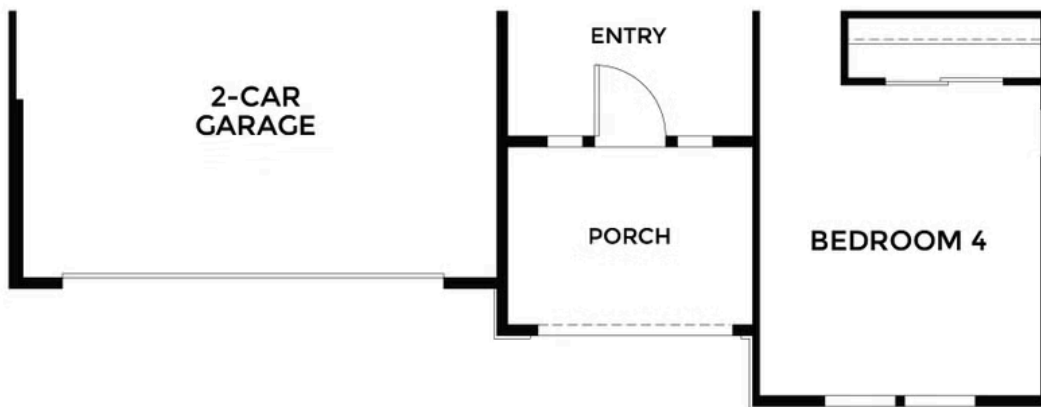

**ELEVATION PRAIRIE
FIRST FLOOR**

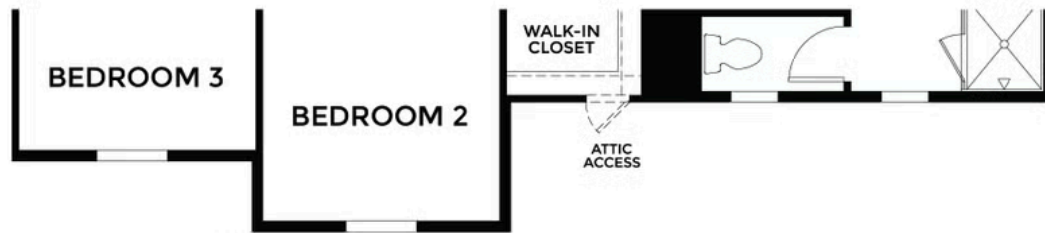

**ELEVATION FARMHOUSE
SECOND FLOOR
(SAME AS SPANISH)**

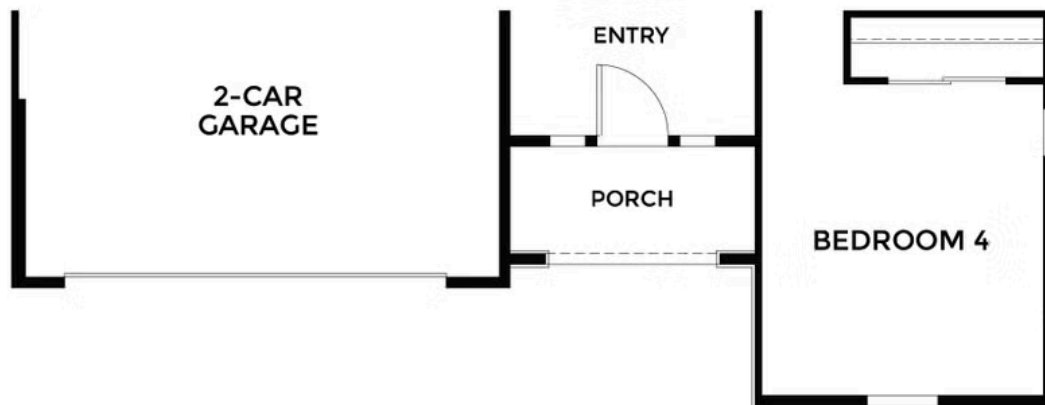

**ELEVATION FARMHOUSE
FIRST FLOOR**

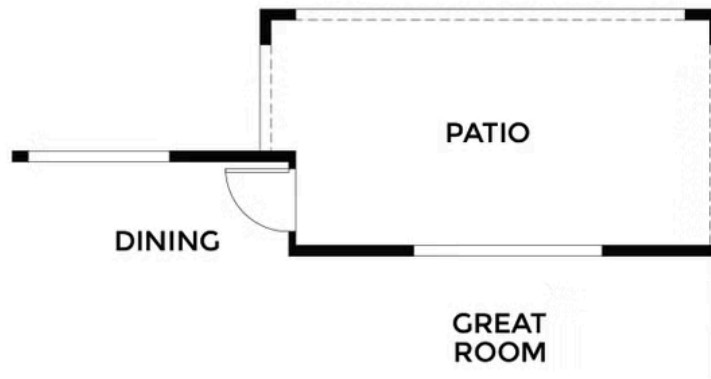

OPTIONAL PATIO



OPTIONAL BEDROOM 5
ILO LOFT